

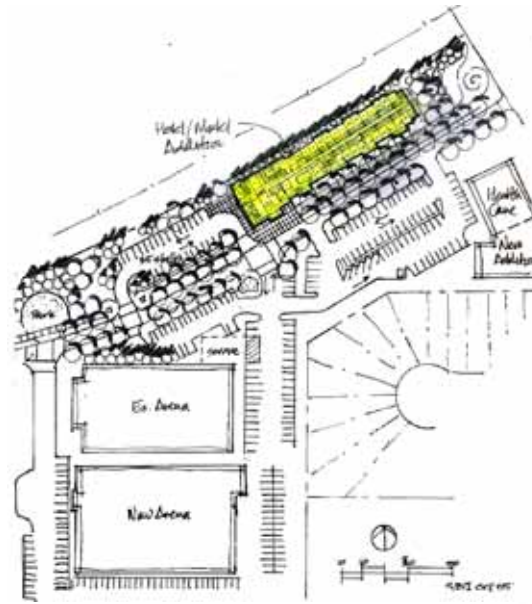

Existing Area South of Railway - Between 50 Street and 46 Street

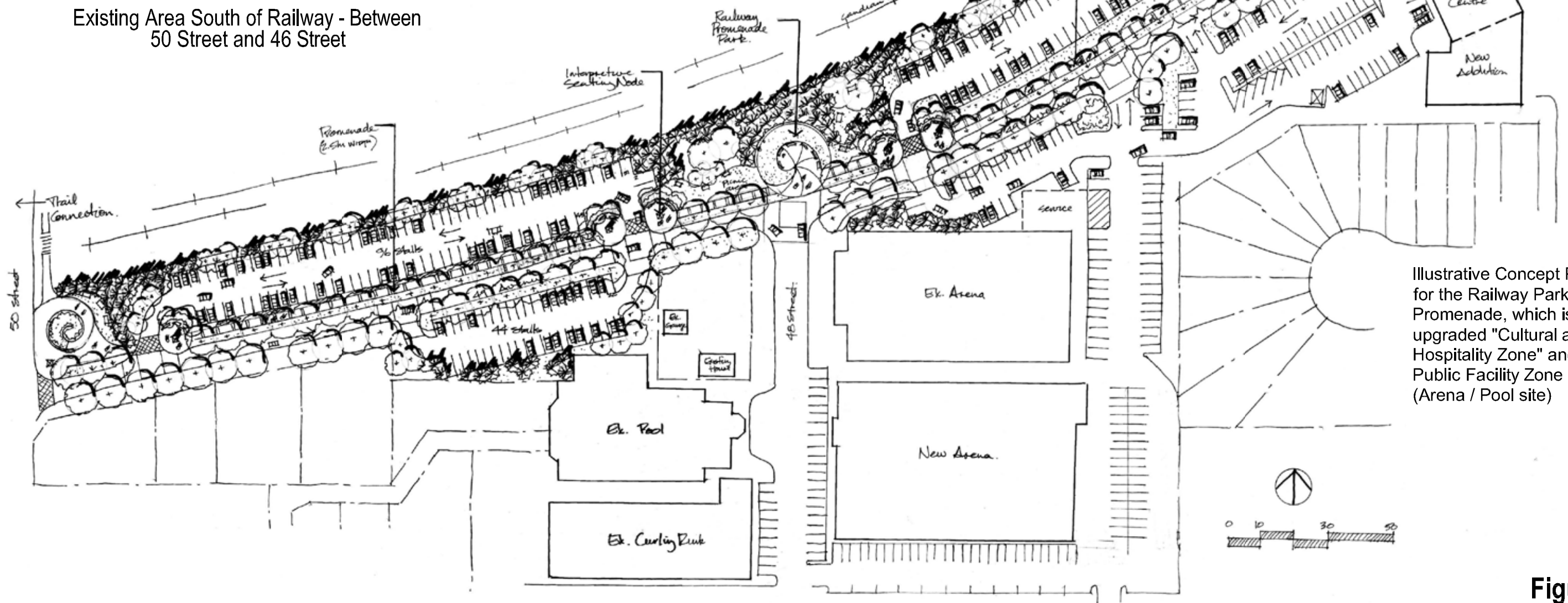

Illustrative Concept Plan for replacement of the proposed gravel parking area with a hotel / motel addition.



Illustrative Concept Plan for the Railway Park Promenade, which is an upgraded "Cultural and Hospitality Zone" and Public Facility Zone (Arena / Pool site)

Note: Illustrations are conceptual and are meant to represent only one possible design solution.

**Figure 8**  
Concept Showing Potential Development of Railway Park Promenade

Date: December 2005